

## WIPER BLADE REPLACEMENT

Fit only replacement wiper blades that are identical to the original specification.

Before changing a wiper blade, the wiper arms must be set in the 'service' position as follows;

**Note:** *The Smart Key must remain in the vehicle while wiper blades are replaced.*

1. Ensure that the ignition is turned off.
2. Turn the ignition on then off again.
3. Immediately push the wiper control down to start the single wipe operation and turn on the ignition again.

The wipers will move to their service position.

4. When the new parts have been fitted, turn the ignition off. This will return the wipers to park position.

**Front wiper blade:** Lift the blade clear of the screen.

1. Push down on the button and hold.
2. Pull the wiper blade away from the button.

When the new blade is pushed into the receiver, the button will click into place.

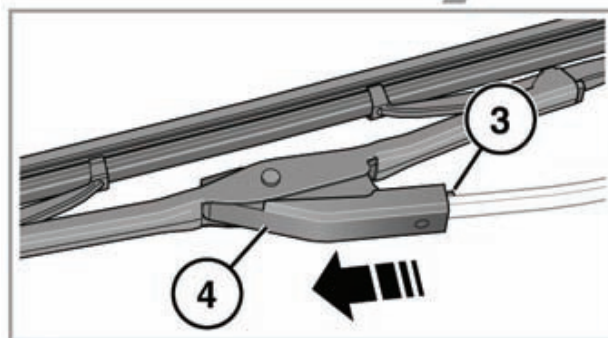
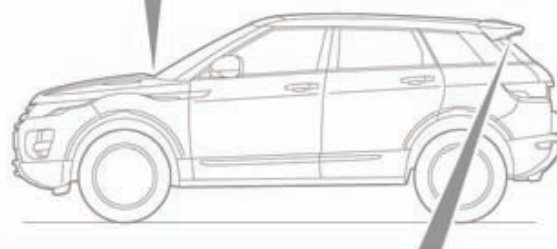
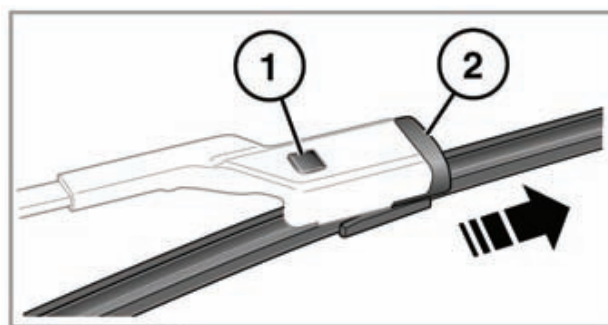

SL1904

**Rear wiper blade:** Lift the blade clear of the screen.

3. Prise the tab out and hold.
4. Slide the blade down the wiper arm to clear the mounting.

When the new blade is pushed into the wiper arm, the tab will click into place.